

REG 7

ERSATZSCHNEIDEN

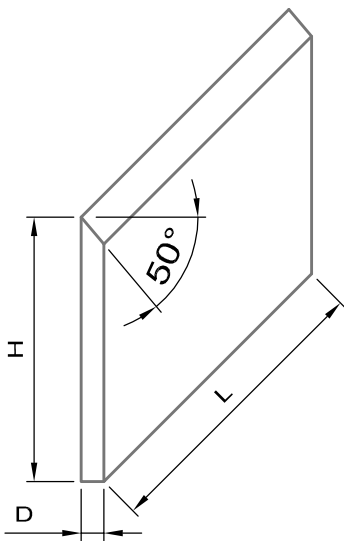

Ausführung:

- HS 18%, vorwiegend zur Bearbeitung von Massivholz weich bis hart

Anwendung:

- Präzise plangeschliffen und gebrauchsfertig scharfgeschliffen, Messerhöhe 30 oder 35mm, mehrfach nachschärfbar.
- Verpackungseinheit (VE) 2 Stk.

L (mm)	H (mm)	D (mm)	Artikelnummer
120	30	3	708HS120303
130	30	3	708HS130303
150	30	3	708HS150303
160	30	3	708HS160303
170	30	3	708HS170303
180	30	3	708HS180303
190	30	3	708HS190303
210	30	3	708HS210303
230	30	3	708HS230303
235	30	3	708HS235303
240	30	3	708HS240303
260	30	3	708HS260303
270	30	3	708HS270303
275	30	3	708HS275303
300	30	3	708HS300303
305	30	3	708HS305303
310	30	3	708HS310303
350	30	3	708HS350303
400	30	3	708HS400303
410	30	3	708HS410303
510	30	3	708HS510303
610	30	3	708HS610303
630	30	3	708HS630303
640	30	3	708HS640303
770	30	3	708HS770303

L (mm)	H (mm)	D (mm)	Artikelnummer
120	35	3	708HS120353
130	35	3	708HS130353
150	35	3	708HS150353
160	35	3	708HS160353
170	35	3	708HS170353
180	35	3	708HS180353
190	35	3	708HS190353
210	35	3	708HS210353
230	35	3	708HS230353
235	35	3	708HS235353
240	35	3	708HS240353
260	35	3	708HS260353
270	35	3	708HS270353
275	35	3	708HS275353
300	35	3	708HS300353
305	35	3	708HS305353
310	35	3	708HS310353
350	35	3	708HS350353
400	35	3	708HS400353
410	35	3	708HS410353
510	35	3	708HS510353
610	35	3	708HS610353
630	35	3	708HS630353
640	35	3	708HS640353
770	35	3	708HS770353

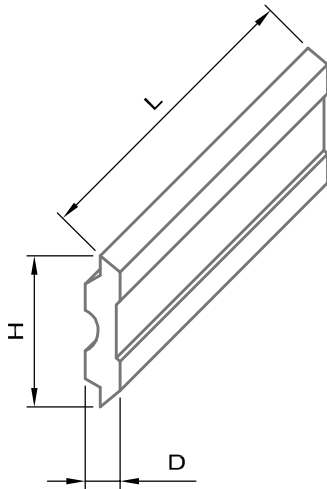

Ausführung:

- HS 18%, vorwiegend zur Bearbeitung von Massivholz weich bis hart

Anwendung:

- Einweg-Wendemesser, nicht nachschärfbar.
- Verpackungseinheit (VE) 2 Stk.

L (mm)	H (mm)	D (mm)	Artikelnummer
60	10	2.3	709HS060
80	10	2.3	709HS080
90	10	2.3	709HS090
100	10	2.3	709HS100
110	10	2.3	709HS110
115	10	2.3	709HS115
120	10	2.3	709HS120
130	10	2.3	709HS130
140	10	2.3	709HS140
150	10	2.3	709HS150
160	10	2.3	709HS160
170	10	2.3	709HS170
180	10	2.3	709HS180
190	10	2.3	709HS190
200	10	2.3	709HS200
210	10	2.3	709HS210
220	10	2.3	709HS220
230	10	2.3	709HS230
240	10	2.3	709HS240
250	10	2.3	709HS250
260	10	2.3	709HS260
270	10	2.3	709HS270
280	10	2.3	709HS280
300	10	2.3	709HS300
310	10	2.3	709HS310

L (mm)	D (mm)	Artikelnummer	
320	10	2.3	709HS320
330	10	2.3	709HS330
350	10	2.3	709HS350
360	10	2.3	709HS360
400	10	2.3	709HS400
410	10	2.3	709HS410
420	10	2.3	709HS420
430	10	2.3	709HS430
450	10	2.3	709HS450
500	10	2.3	709HS500
510	10	2.3	709HS510
520	10	2.3	709HS520
530	10	2.3	709HS530
540	10	2.3	709HS540
600	10	2.3	709HS600
610	10	2.3	709HS610
630	10	2.3	709HS630
635	10	2.3	709HS635
640	10	2.3	709HS640
650	10	2.3	709HS650

7

M42-TERSA-HOBELMESSER 709M42

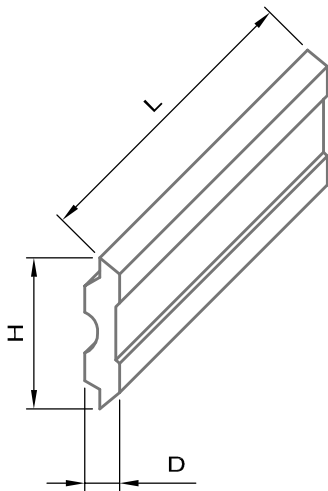

Ausführung:

- M42, vorwiegend zur Bearbeitung von Massivholz weich bis hart

Anwendung:

- Einweg-Wendemesser, nicht nachschärfbar.
- Verpackungseinheit (VE) 2 Stk.

L (mm)	H (mm)	D (mm)	Artikelnummer
60	10	2.3	709M42060
80	10	2.3	709M42080
90	10	2.3	709M42090
100	10	2.3	709M42100
110	10	2.3	709M42110
115	10	2.3	709M42115
120	10	2.3	709M42120
130	10	2.3	709M42130
140	10	2.3	709M42140
150	10	2.3	709M42150
160	10	2.3	709M42160
170	10	2.3	709M42170
180	10	2.3	709M42180
190	10	2.3	709M42190
200	10	2.3	709M42200
210	10	2.3	709M42210
220	10	2.3	709M42220
230	10	2.3	709M42230
240	10	2.3	709M42240
250	10	2.3	709M42250
260	10	2.3	709M42260
270	10	2.3	709M42270
280	10	2.3	709M42280
300	10	2.3	709M42300
310	10	2.3	709M42310

L (mm)	H (mm)	D (mm)	Artikelnummer
320	10	2.3	709M42320
330	10	2.3	709M42330
350	10	2.3	709M42350
360	10	2.3	709M42360
400	10	2.3	709M42400
410	10	2.3	709M42410
420	10	2.3	709M42420
430	10	2.3	709M42430
450	10	2.3	709M42450
500	10	2.3	709M42500
510	10	2.3	709M42510
520	10	2.3	709M42520
530	10	2.3	709M42530
540	10	2.3	709M42540
600	10	2.3	709M42600
610	10	2.3	709M42610
630	10	2.3	709M42630
635	10	2.3	709M42635
640	10	2.3	709M42640
650	10	2.3	709M42650
660	10	2.3	709M42660



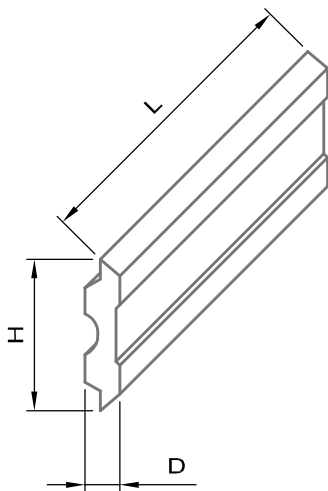

Ausführung:

- HW massiv, vorwiegend zur Bearbeitung von Hartholz, verleimten Holz und Plattenwerkstoffen

Anwendung:

- Einweg-Wendemesser, nicht nachschärfbar.
- Verpackungseinheit (VE) 2 Stk.

L (mm)	H (mm)	D (mm)	Artikelnummer
60	10	2.3	709HW060
80	10	2.3	709HW080
90	10	2.3	709HW090
100	10	2.3	709HW100
110	10	2.3	709HW110
115	10	2.3	709HW115
120	10	2.3	709HW120
130	10	2.3	709HW130
140	10	2.3	709HW140
150	10	2.3	709HW150
160	10	2.3	709HW160
170	10	2.3	709HW170
180	10	2.3	709HW180
190	10	2.3	709HW190
200	10	2.3	709HW200
210	10	2.3	709HW210
220	10	2.3	709HW220
230	10	2.3	709HW230
240	10	2.3	709HW240
250	10	2.3	709HW250
260	10	2.3	709HW260
270	10	2.3	709HW270
280	10	2.3	709HW280
300	10	2.3	709HW300
310	10	2.3	709HW310

L (mm)	H (mm)	D (mm)	Artikelnummer
320	10	2.3	709HW320
330	10	2.3	709HW330
350	10	2.3	709HW350
360	10	2.3	709HW360
400	10	2.3	709HW400
410	10	2.3	709HW410
415	10	2.3	709HW415
420	10	2.3	709HW420
430	10	2.3	709HW430
450	10	2.3	709HW450
500	10	2.3	709HW500
510	10	2.3	709HW510
520	10	2.3	709HW520
530	10	2.3	709HW530
540	10	2.3	709HW540
600	10	2.3	709HW600
610	10	2.3	709HW610
630	10	2.3	709HW630
635	10	2.3	709HW635
640	10	2.3	709HW640
650	10	2.3	709HW650

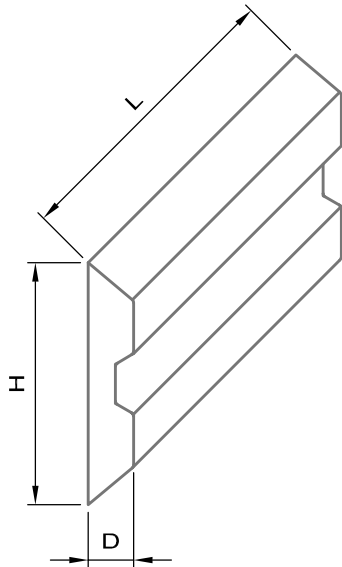

Ausführung:

- HS 18%, vorwiegend zur Bearbeitung von Massivholz weich bis hart

Anwendung:

- Wendemesser nachschärfbar
- Verpackungseinheit (VE) 4 Stk.

L (mm)	H (mm)	D (mm)	Artikelnummer
10	16	3	714HS010CL
20	16	3	714HS020CL
30	16	3	714HS030CL
40	16	3	714HS040CL
50	16	3	714HS050CL
60	16	3	714HS060CL
65	16	3	714HS065CL
80	16	3	714HS080CL
100	16	3	714HS100CL
115	16	3	714HS115CL
120	16	3	714HS120CL
130	16	3	714HS130CL
140	16	3	714HS140CL
150	16	3	714HS150CL
160	16	3	714HS160CL
170	16	3	714HS170CL
180	16	3	714HS180CL
190	16	3	714HS190CL
210	16	3	714HS210CL
220	16	3	714HS220CL
230	16	3	714HS230CL
235	16	3	714HS235CL
240	16	3	714HS240CL
250	16	3	714HS250CL
260	16	3	714HS260CL
270	16	3	714HS270CL
285	16	3	714HS285CL
300	16	3	714HS300CL
310	16	3	714HS310CL
410	16	3	714HS410CL
460	16	3	714HS460CL
650	16	3	714HS650CL

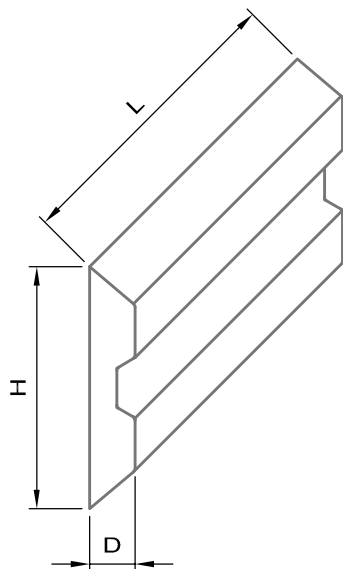

Ausführung:

- HW massiv, vorwiegend zur Bearbeitung von Hartholz, verleimten Holz und Plattenwerkstoffen

Anwendung:

- Wendemesser nachschärfbar
- Verpackungseinheit (VE) 4 Stk.

L (mm)	H (mm)	D (mm)	Artikelnummer
10	16	3	715HW010CL
20	16	3	715HW020CL
30	16	3	715HW030CL
40	16	3	715HW040CL
50	16	3	715HW050CL
60	16	3	715HW060CL
65	16	3	715HW065CL
80	16	3	715HW080CL
100	16	3	715HW100CL
115	16	3	715HW115CL
120	16	3	715HW120CL
130	16	3	715HW130CL
140	16	3	715HW140CL
150	16	3	715HW150CL
160	16	3	715HW160CL
170	16	3	715HW170CL
180	16	3	715HW180CL
190	16	3	715HW190CL
210	16	3	715HW210CL
220	16	3	715HW220CL
230	16	3	715HW230CL
240	16	3	715HW240CL
260	16	3	715HW260CL
270	16	3	715HW270CL
300	16	3	715HW300CL
310	16	3	715HW310CL
460	16	3	715HW460CL
650	16	3	715HW650CL

HS-CENTROFIX-HOBELMESSER 18°/736

HS-CENTROSTAR

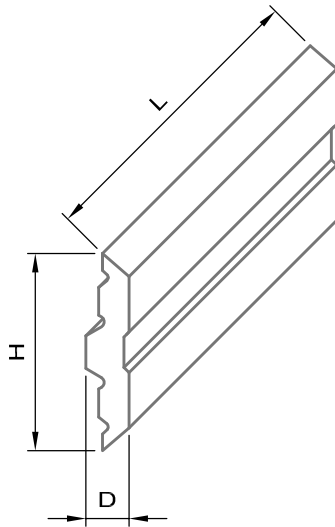

Ausführung:

- HS 18%, vorwiegend zur Bearbeitung von Massivholz weich bis hart

Anwendung:

- Präzise- und gebrauchsfertig scharfgeschliffen, Wendemesser nicht nachschärfbar
- Verpackungseinheit (VE) 4 Stk.

L (mm)	H (mm)	D (mm)	Artikelnummer
50	12	2.85	736HS050CF
80	12	2.85	736HS080CF
100	12	2.85	736HS100CF
120	12	2.85	736HS120CF
130	12	2.85	736HS130CF
136	12	2.85	736HS136CF
150	12	2.85	736HS150CF
170	12	2.85	736HS170CF
180	12	2.85	736HS180CF
190	12	2.85	736HS0190CF
210	12	2.85	736HS210CF
230	12	2.85	736HS230CF
240	12	2.85	736HS240CF
310	12	2.85	736HS310CF
400	12	2.85	736HS400CF
410	12	2.85	736HS410CF
420	12	2.85	736HS420CF
430	12	2.85	736HS430CF
500	12	2.85	736HS500CF
510	12	2.85	736HS510CF
520	12	2.85	736HS520CF
530	12	2.85	736HS530CF
540	12	2.85	736HS540CF
630	12	2.85	736HS630CF
640	12	2.85	736HS640CF
650	12	2.85	736HS650CF

HW-CENTROSTAR

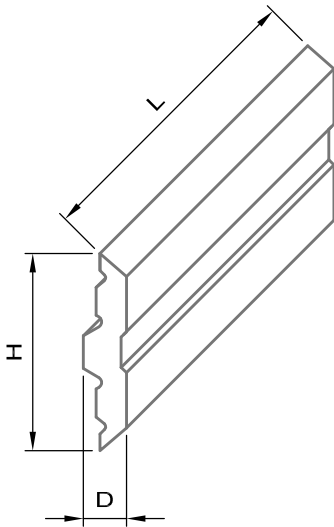

Ausführung:

- HW massiv, vorwiegend zur Bearbeitung von Hartholz, verleimten Holz und Plattenwerkstoffen

Anwendung:

- Wendemesser nicht nachschärfbar
- Verpackungseinheit (VE) 4 Stk.

L (mm)	H (mm)	D (mm)	Artikelnummer
50	12	2.85	737HW050CF
80	12	2.85	737HW080CF
100	12	2.85	737HW100CF
120	12	2.85	737HW120CF
130	12	2.85	737HW130CF
136	12	2.85	737HW136CF
150	12	2.85	737HW150CF
170	12	2.85	737HW170CF
180	12	2.85	737HW180CF
190	12	2.85	737HW190CF
210	12	2.85	737HW210CF
230	12	2.85	737HW230CF
240	12	2.85	737HW240CF
310	12	2.85	737HW310CF
400	12	2.85	737HW400CF
410	12	2.85	737HW410CF
420	12	2.85	737HW420CF
430	12	2.85	737HW430CF
500	12	2.85	737HW500CF
510	12	2.85	737HW510CF
520	12	2.85	737HW520CF
530	12	2.85	737HW530CF
540	12	2.85	737HW540CF
630	12	2.85	737HW630CF
640	12	2.85	737HW640CF
650	12	2.85	737HW650CF



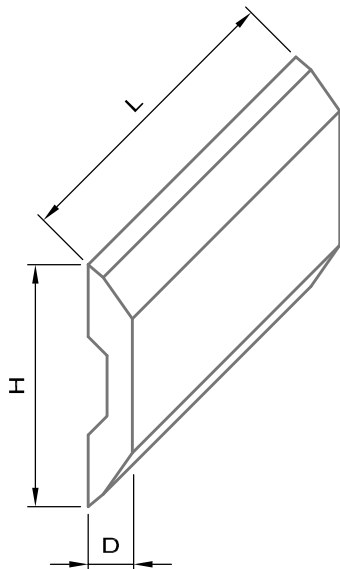

Ausführung:

- HS 18%, vorwiegend zur Bearbeitung von Massivholz weich bis hart

Anwendung:

- Wendemesser nachschärfbar
- Verpackungseinheit (VE) 4 Stk.

L (mm)	H (mm)	D (mm)	Artikelnummer
80	16	2.5	764HS080SINUS
100	16	2.5	764HS100SINUS
120	16	2.5	764HS120SINUS
130	16	2.5	764HS130SINUS
140	16	2.5	764HS140SINUS
150	16	2.5	764HS150SINUS
160	16	2.5	764HS160SINUS
180	16	2.5	764HS180SINUS
190	16	2.5	764HS190SINUS
200	16	2.5	764HS200SINUS
210	16	2.5	764HS210SINUS
220	16	2.5	764HS220SINUS
230	16	2.5	764HS230SINUS
240	16	2.5	764HS240SINUS
250	16	2.5	764HS250SINUS
260	16	2.5	764HS260SINUS
300	16	2.5	764HS300SINUS
310	16	2.5	764HS310SINUS
400	16	2.5	764HS400SINUS
410	16	2.5	764HS410SINUS
430	16	2.5	764HS430SINUS
500	16	2.5	764HS500SINUS
510	16	2.5	764HS510SINUS
610	16	2.5	764HS610SINUS
630	16	2.5	764HS630SINUS
640	16	2.5	764HS640SINUS
710	16	2.5	764HS710SINUS



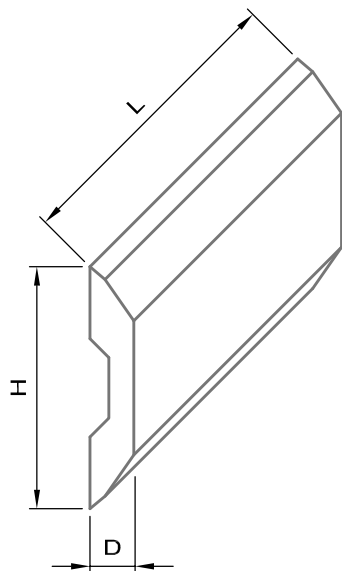

Ausführung:

- HW massiv, vorwiegend zur Bearbeitung von Hartholz, verleimten Holz und Plattenwerkstoffen

Anwendung:

- Wendemesser nachschärfbar
- Verpackungseinheit (VE) 4 Stk.

L (mm)	H (mm)	D (mm)	Artikelnummer
80	16	2.5	763HW080SINUS
100	16	2.5	763HW100SINUS
120	16	2.5	763HW120SINUS
130	16	2.5	763HW130SINUS
140	16	2.5	763HW140SINUS
150	16	2.5	763HW150SINUS
160	16	2.5	763HW160SINUS
180	16	2.5	763HW180SINUS
200	16	2.5	763HW200SINUS
210	16	2.5	763HW210SINUS
220	16	2.5	763HW220SINUS
230	16	2.5	763HW230SINUS
240	16	2.5	763HW240SINUS
250	16	2.5	763HW250SINUS
260	16	2.5	763HW260SINUS
300	16	2.5	763HW300SINUS
310	16	2.5	763HW310SINUS
400	16	2.5	763HW400SINUS
410	16	2.5	763HW410SINUS
430	16	2.5	763HW430SINUS
500	16	2.5	763HW500SINUS
510	16	2.5	763HW510SINUS
610	16	2.5	763HW610SINUS
630	16	2.5	763HW630SINUS
640	16	2.5	763HW640SINUS



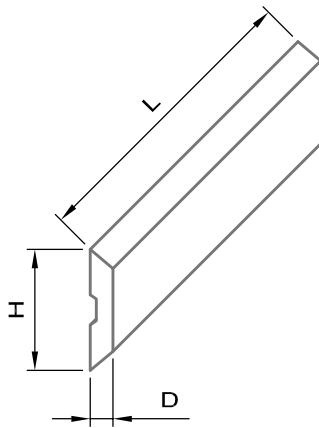

Anwendung:

- Hartmetallsorte K05/T04F geeignet für HDF, MDF + / Spanplatte++
Hartholz + / Weichholz + / Verleimholz +
- Hartmetallsorte K10-K40/T10MG geeignet für Hartholz + / Weichholz ++
- Verpackungseinheit (VE) 10 Stk.

L (mm)	H (mm)	D (mm)	Artikelnummer K05/T04F	Artikelnummer T10MG
7.7	8	1.5	73500770815	76000770815
9.7	8	1.5	73500970815	76000970815
11.7	8	1.5	73501170815	76001170815
14.7	8	1.5	73501470815	76001470815
19.7	8	1.5	73501970815	76001970815
24.7	8	1.5	73502470815	76002470815
30.0	8	1.5	73503000815	76003000815
35.0	8	1.5	73503500815	76003500815
40.0	8	1.5	73504000815	76004000815
45.0	8	1.5	73504500815	76004500815
50.0	8	1.5	73505000815	76005000815
60.0	8	1.5	73506000815	76006000815
70.0	8	1.5	73507000815	76007000815
80.0	8	1.5	73508000815	76008000815
100.0	8	1.5	73510000815	76010000815

WENDEPLATTEN-SYSTEM ÖRTL

Anwendung:

- Hartmetallsorte K05/T04F geeignet für HDF, MDF + / Spanplatte++
Hartholz + / Weichholz + / Verleimholz +
- Hartmetallsorte K10-K40/T10MG geeignet für Hartholz + / Weichholz ++
- Verpackungseinheit (VE) 10 Stk.

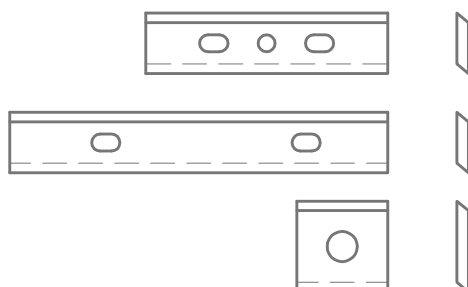
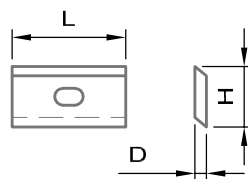

L (mm)	H (mm)	D (mm)	Artikelnummer T04F	Artikelnummer T10MG
8.8	8	1.5	73000880815	73400880815
9.0	8	1.5	73000900815	73400900815
9.5	8	1.5	73000950815	73400950815
11.0	8	1.5	73001100815	73401100815
12.0	8	1.5	73001200815	73401200815
15.0	8	1.5	73001500815	73401500815
20.0	8	1.5	73002000815	73402000815
25.0	8	1.5	73002500815	73402500815
28.0	8	1.5	73002800815	73402800815
32.0	8	1.5	73003200815	73403200815
40.0	8	1.5	73004000815	73404000815
50.0	8	1.5	73005000815	73405000815
60.0	8	1.5	73006000815	73406000815
80.0	8	1.5	73008000815	73408000815
100.0	8	1.5	73010000815	73410000815
12.0	12.0	1.5	73001201215	73401201215

WENDEPLATTE KW55°

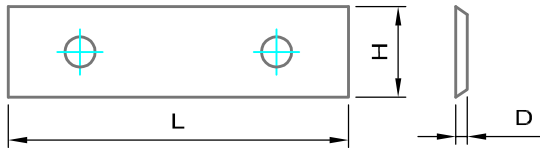

Anwendung:

- Hartmetallsorte K05/T04F geeignet für HDF, MDF + / Spanplatte++ / Hartholz + / Weichholz + Verleimholz +
- Verpackungseinheit (VE) 10 Stk.

L (mm)	H (mm)	D (mm)	Artikelnummer K05/T04F
7.6	12	1.5	7030761215
8.6	12	1.5	7030861215
9.0	12	1.5	7030901215
9.6	12	1.5	7030961215
11.6	12	1.5	7031161215
12.0	12	1.5	7031201215
15.0	12	1.5	7031501215
16.0	12	2.0	7031601220
18.0	12	1.5	7031801215
19.5	12	1.5	7031951215
20.0	12	1.5	7032001215
25.0	12	1.5	7032501215
30.0	12	1.5	7033001215
40.0	12	1.5	7034001215
49.5	12	1.5	7034951215
50.0	12	1.5	7035001215
50.0	12	1.7	7035001217
60.0	12	1.5	7036001215

WENDEPLATTE KW45°

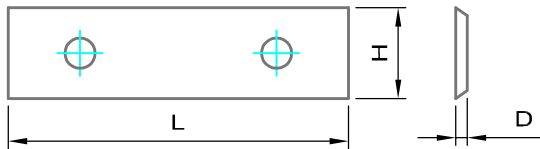

Anwendung:

- Hartmetallsorte K05/T04F geeignet für HDF, MDF + / Spanplatte++ / Hartholz + / Weichholz + Verleimholz +
- Verpackungseinheit (VE) 10 Stk.

L (mm)	H (mm)	D (mm)	Artikelnummer K05/T04F
7.6	12	1.5	7050761215
8.6	12	1.5	7050861215
9.0	12	1.5	7050901215
9.6	12	1.5	7050961215
11.6	12	1.5	7051161215
12.0	12	1.5	7051201215
15.0	12	1.5	7051501215
16.0	12	2.0	7051601220
18.0	12	1.5	7051801215
19.5	12	1.5	7051951215
20.0	12	1.5	7052001215
25.0	12	1.5	7052501215
30.0	12	1.5	7053001215
40.0	12	1.5	7054001215
49.5	12	1.5	7054951215
50.0	12	1.5	7055001215
50.0	12	1.7	7055001217
60.0	12	1.5	7056001215

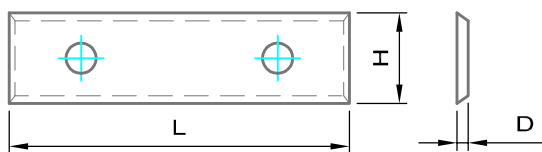

Anwendung:

- Hartmetallsorte K05/T04F geeignet für HDF, MDF + / Spanplatte++ / Hartholz + / Weichholz + Verleimholz +
- Verpackungseinheit (VE) 10 Stk.

L (mm)	H (mm)	D (mm)	Artikelnummer K05/T04F
19.5	7	1.5	7031950715
19.5	7.5	1.5	7031957515
19.5	8	1.5	7031950815
19.5	9	1.5	7031950915
19.5	10	1.5	7031951015
19.5	11	1.5	7031951115
19.5	12	1.5	7031951215
29.5	7	1.5	7032950715
29.5	7.5	1.5	7032957515
29.5	8	1.5	7032950815
29.5	9	1.5	7032950915
29.5	10	1.5	7032951015
29.5	11	1.5	7032951115
29.5	12	1.5	7032951215
39.5	9	1.5	7033950915
39.5	12	1.5	7033951215
49.5	8	1.5	7034950815
49.5	9	1.5	7034950915
49.5	10	1.5	7034951015
49.5	11	1.5	7034951115
49.5	12	1.5	7034951215
59.5	12	1.5	7035951215

L (mm)	H (mm)	D (mm)	Artikelnummer K05/T04F
50.0	9	1.5	703500915
50.0	10	1.7	703501017
50.0	12	1.7	703501217
16.0	7	1.5	703160715
23.0	7	1.5	703230715
28.0	7	1.5	703280715
16.0	7	1.5	703160715
16.0	7	1.5	703160715
23.0	7	1.5	703230715
23.0	7	1.5	703230715
31.5	9	1.5	7033150915



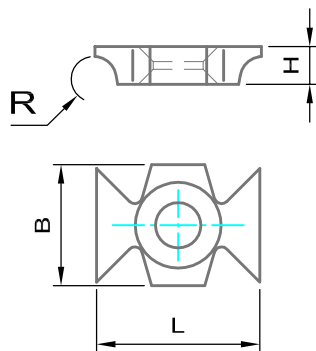

Anwendung:

- Hartmetallsorte K05 geeignet für HDF, MDF + Spanplatte++ / Hartholz + / Weichholz + Verleimholz +
- Verpackungseinheit (VE) 2 Stk.

L (mm)	B (mm)	H (mm)	R (mm)	Artikelnummer
22	16	5	1	7071622501
40	16	5	1.5	7071622515
40	16	5	2	7071622502
40	16	5	2.5	7071622525
40	16	5	3	7071622503
40	16	5	4	7071622504
40	16	5	45°	7071622545

HW-KANTENMESSER MAN

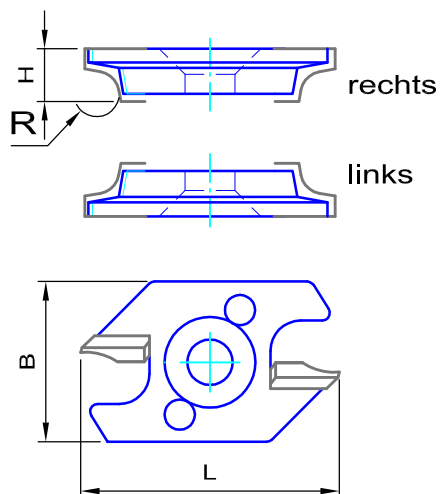

Anwendung:

- Hartmetallsorte K05 geeignet für HDF, MDF + Spanplatte++ / Hartholz + / Weichholz + Verleimholz +
- Verpackungseinheit (VE) 2 Stk.

L (mm)	B (mm)	H (mm)	R (mm)	Artikelnummer (R)	Artikelnummer (L)
35	22	7	2	S7.0715.5	S7.0716.5
35	22	7	2.5	S7.1547.5	S7.1548.5
35	22	7	3	S7.0719.5	S7.0720.5
35	22	7	45°	S7.1575.5	S7.1576.5

7

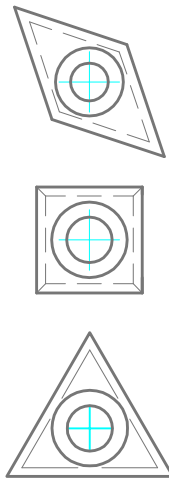

Anwendung:

- Hartmetallsorte K05/T04F geeignet für HDF, MDF + Spanplatte++ / Hartholz + / Weichholz + Verleimholz +
- Verpackungseinheit (VE) 10 Stk.

L (mm)	H (mm)	D (mm)		Artikelnummer K05/T04F
14	28	2.0	30°	AA
16	16	3.0	32°	AA
14	14	1.2		702141412
14	14	2.0		702141420
15	15	2.5	R50	702151525A
15	15	2.5	R75	702151525B
15	15	2.5	R150	702151525
15	15	2.5	30°	70215152530
15	15	2.5	37°	70215152537
22	22	2.0		70222222001
22	19	2.0		70222019020

VHM-NUTMESSER MEC

707

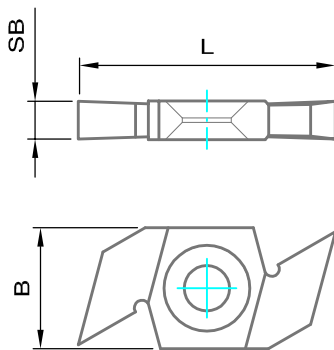

Anwendung:

- Hartmetallsorte K05/T04F geeignet für HDF, MDF + / Spanplatte++ / Hartholz + / Weichholz + Verleimholz +
- Verpackungseinheit (VE) 2 Stk.

L (mm)	B (mm)	SB (mm)	Artikelnummer K05/T04F
34	16	3	70716034030
34	16	4	70716034040
34	16	5	70716034050

HW-NUTMESSER MAN

707

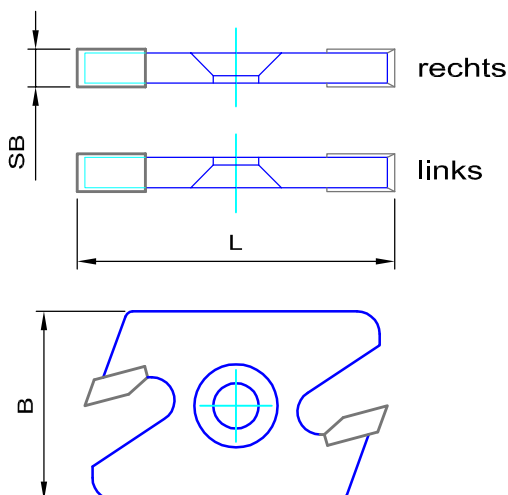

Anwendung:

- Hartmetallsorte K05 geeignet für HDF, MDF + Spanplatte++ / Hartholz + / Weichholz + Verleimholz +
- Verpackungseinheit (VE) 2 Stk.

L (mm)	B (mm)	SB (mm)	Artikelnummer
40	16	4	S7.0090.4R
40	16	4	S7.0090.4L
40	16	5	S7.0091.4R
40	16	5	S7.0091.4L

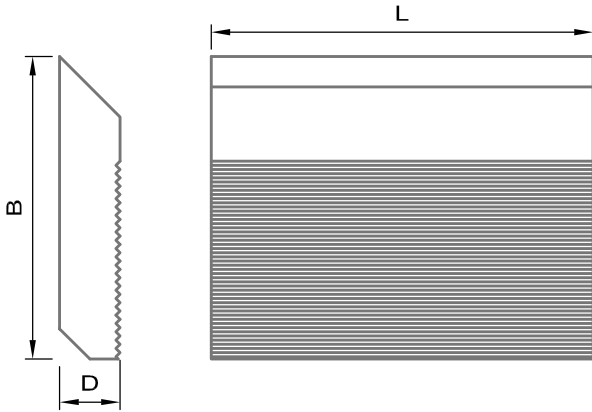

Anwendung:

- für Profilmesserköpfe mit 90° Rückenverzahnung
- Messerdicke 8mm
- Für Weich- und Hartholz
- H=40mm: zum Hobeln
- H=50mm: PT max. 12mm
- H=60mm: PT max. 18mm
- H=70mm: PT max. 30mm

Bitte Flugkreisdurchmesser des Messerkopfes mit eingesetzten Messern beachten!
Siehe Flugkreistabelle auf Seite 7.18!

L (mm)	B (mm)	D (mm)	Artikelnummer
40.0	40	8.0	711HR040408
50.0	40	8.0	711HR050408
60.0	40	8.0	711HR060408
70.0	40	8.0	711HR070408
80.0	40	8.0	711HR080408
90.0	40	8.0	711HR090408
100.0	40	8.0	711HR100408
110.0	40	8.0	711HR110408
120.0	40	8.0	711HR120408
130.0	40	8.0	711HR130408
150.0	40	8.0	711HR150408
170.0	40	8.0	711HR170408
180.0	40	8.0	711HR180408
200.0	40	8.0	711HR200408
210.0	40	8.0	711HR210408
230.0	40	8.0	711HR230408
260.0	40	8.0	711HR260408
650.0	40	8.0	711HR650408

L (mm)	B (mm)	D (mm)	Artikelnummer
40.0	60	8.0	711HR040608
50.0	60	8.0	711HR050608
60.0	60	8.0	711HR060608
70.0	60	8.0	711HR070608
80.0	60	8.0	711HR080608
90.0	60	8.0	711HR090608
100.0	60	8.0	711HR100608
110.0	60	8.0	711HR110608
120.0	60	8.0	711HR120608
130.0	60	8.0	711HR130608
150.0	60	8.0	711HR150608
170.0	60	8.0	711HR170608
180.0	60	8.0	711HR180608
200.0	60	8.0	711HR200608
210.0	60	8.0	711HR210608
230.0	60	8.0	711HR230608
260.0	60	8.0	711HR260608
650.0	60	8.0	711HR650608

40.0	50	8.0	711HR040508
50.0	50	8.0	711HR050508
60.0	50	8.0	711HR060508
70.0	50	8.0	711HR070508
80.0	50	8.0	711HR080508
90.0	50	8.0	711HR090508
100.0	50	8.0	711HR100508
110.0	50	8.0	711HR110508
120.0	50	8.0	711HR120508
130.0	50	8.0	711HR130508
150.0	50	8.0	711HR150508
170.0	50	8.0	711HR170508
180.0	50	8.0	711HR180508
200.0	50	8.0	711HR200508
210.0	50	8.0	711HR210508
230.0	50	8.0	711HR230508
260.0	50	8.0	711HR260508
650.0	50	8.0	711HR650508

40.0	70	8.0	711HR040708
50.0	70	8.0	711HR050708
60.0	70	8.0	711HR060708
70.0	70	8.0	711HR070708
80.0	70	8.0	711HR080708
90.0	70	8.0	711HR090708
100.0	70	8.0	711HR100708
110.0	70	8.0	711HR110708
120.0	70	8.0	711HR120708
130.0	70	8.0	711HR130708
150.0	70	8.0	711HR150708
170.0	70	8.0	711HR170708
180.0	70	8.0	711HR180708
200.0	70	8.0	711HR200708
210.0	70	8.0	711HR210708
230.0	70	8.0	711HR230708
260.0	70	8.0	711HR260708
650.0	70	8.0	711HR650708

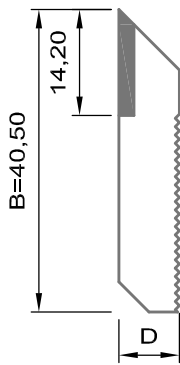

L (mm)	B (mm)	D (mm)	Artikelnummer
40.0	40	10.0	740HW0404010
60.0	40	10.0	740HW0604010
80.0	40	10.0	740HW0804010
100.0	40	10.0	740HW1004010
130.0	40	10.0	740HW1304010
150.0	40	10.0	740HW1504010
180.0	40	10.0	740HW1804010
200.0	40	10.0	740HW2004010
230.0	40	10.0	740HW2304010
260.0	40	10.0	740HW2604010
310.0	40	10.0	740HW3104010
640.0	40	10.0	740HW6404010
650.0	40	10.0	740HW6504010
40.0	50	10.0	740HW0405010
60.0	50	10.0	740HW0605010
80.0	50	10.0	740HW0805010
100.0	50	10.0	740HW1005010
130.0	50	10.0	740HW1305010
150.0	50	10.0	740HW1505010
180.0	50	10.0	740HW1805010
200.0	50	10.0	740HW2005010
230.0	50	10.0	740HW2305010
260.0	50	10.0	740HW2605010
310.0	50	10.0	740HW3105010
560.0	50	10.0	740HW5605010
640.0	50	10.0	740HW6405010
650.0	50	10.0	740HW6505010

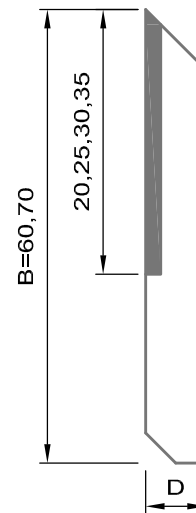

L (mm)	B (mm)	D (mm)	Artikelnummer
40.0	60	10.0	740HW0406010
60.0	60	10.0	740HW0606010
80.0	60	10.0	740HW0806010
100.0	60	10.0	740HW1006010
120.0	60	10.0	740HW1206010
130.0	60	10.0	740HW01306010
150.0	60	10.0	740HW1506010
180.0	60	10.0	740HW1806010
200.0	60	10.0	740HW2006010
230.0	60	10.0	740HW2306010
260.0	60	10.0	740HW2606010
310.0	60	10.0	740HW3106010
560.0	60	10.0	740HW5606010
640.0	60	10.0	740HW6406010
60.0	70	10.0	740HW0607010
80.0	70	10.0	740HW0807010
100.0	70	10.0	740HW1007010
640.0	70	10.0	740HW6407010

Flugkreistabelle zu Seite 7.16+7.17!

D Kopf (mm)	H 40mm	H 50mm	H 60mm	H 70mm
122	142	162	182	202
135	154	174	194	214
145	164	184	204	224
150	169	189	209	229
165	184	204	224	244
170	189	209	229	249
190	209	229	249	269

